

◎ POWER RATING

Intermittent rating kW(PS) / rpm	Max. torque N.m(kg.m) / rpm	Fuel consumption g/kW.h(g/PS.h) / rpm
213 (290) / 2,200	1095 (111.7) / 1,600	219 (161) / 2,200

1. The engine performance corresponds to ISO 3046, DIN 6270B.
2. Continuous power rating is to 169kW(230ps) @2200rpm.

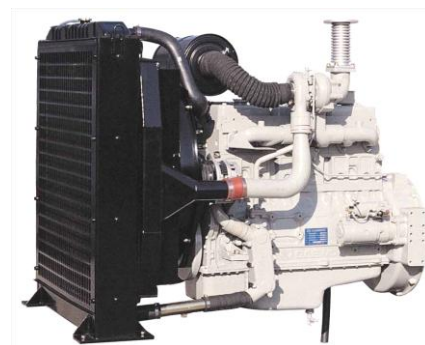

◎ MECHANICAL SYSTEM

- Engine Model PU086TI
- Engine Type In-line 4 cycle, water cooled
Turbo charged & intercooled
- Combustion type Direct injection
- Cylinder Type Replaceable dry liner
- Number of cylinders 6
- Bore x stroke 111(4.37) x 139(5.47) mm(in.)
- Displacement 8.071(492.49) lit.(in3)
- Compression ratio 16.7 : 1
- Firing order 1-5-3-6-2-4
- Injection timing 15° BTDC
- Compression pressure Above 28 kg/cm²(398 psi) at 200rpm
- Dry weight Approx. 792 kg (1,746 lb)
- Dimension 1,242 x 918 x 1,100 mm
(LxWxH) (48.9 x 36.1 x 43.3 in.)
- Rotation Counter clockwise viewed from Flywheel
- Fly wheel housing SAE NO.1M
- Fly wheel Clutch NO.14M

◎ MECHANISM

- Type Over head valve
- Number of valve Intake 1, exhaust 1 per cylinder
- Valve lashes at cold Intake 0.30 mm(0.0118 in)
Exhaust 0.30 mm(0.0118 in.)

◎ VALVE TIMING

- | | Opening | Close |
|-----------------|--------------|--------------|
| ○ Intake valve | 16 deg. BTDC | 36 deg. ABDC |
| ○ Exhaust valve | 46 deg. BBDC | 14 deg. ATDC |

◎ OPTION & ACCESSORY PARTS

- Engine parts Fly wheel & housing
Intake & exhaust manifold
- Accessory parts Raditor, silencer & air cleaner
- Electrical parts Gauge panel & stop solenoid

◎ FUEL SYSTEM

- Injection pump Zexel in-line "PE6P" type
- Governor RSV type(all speed control)
- Feed pump Mechanical type
- Injection nozzle Multi hole type
- Opening pressure 224 kg/cm² (3,186 psi)
- Fuel filter Full flow, cartridge type
- Used fuel Diesel fuel oil

◎ LUBRICATION SYSTEM

- Lub. Method Fully forced pressure feed type
- Oil pump Gear type driven by crankshaft
- Oil filter Full flow, cartridge type
- Oil pan capacity High level 15 liters (4.09 gal.)
Low level 12 liters (3.17 gal.)
- Angularity limit Front down 25 deg.
Front up 25 deg.
Side to side 25 deg.
- Lub. Oil Refer to Operation Manual

◎ PERFORMANCE CURVE

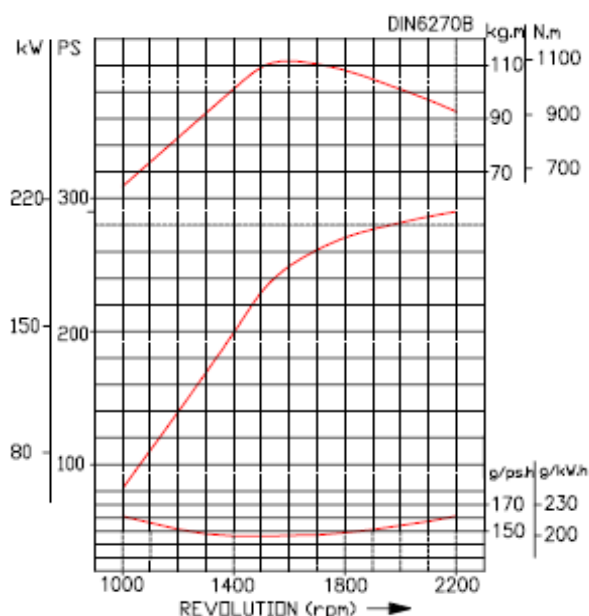

◎ COOLING SYSTEM

○ Cooling method	Fresh water forced circulation
○ Water capacity (engine only)	14 liters (3.70 gal.)
○ Pressure system	Max. 0.9 kg/cm ² (12.8 psi)
○ Water pump	Centrifugal type driven by belt
○ Water pump Capacity	250 liters (66.0 gal.)/min at 2,200 rpm (engine)
○ Thermostat	Wax – pellet type Opening temp. 71 °C Full open temp. 85 °C
○ Cooling fan	Blower type, plastic 660 mm diameter, 7 blade

◎ ELECTRICAL SYSTEM

○ Charging generator	24V x 45A alternator
○ Voltage regulator	Built-in type IC regulator
○ Starting motor	24V x 4.5kW
○ Battery Voltage	24V
○ Battery Capacity	100 AH (recommended)
○ Starting aid (Option)	Block heater

◎ ENGINEERING DATA

○ Water flow	250 liters/min @2,200 rpm
○ Heat rejection to coolant	29.7 kcal/sec @2,200 rpm
○ Air flow	25.1 m ³ /min @2,200 rpm
○ Exhaust gas flow	40.1 m ³ /min @2,200 rpm
○ Exhaust gas temp.	450 °C @2,200 rpm
○ Max. permissible restrictions	
-Intake system	220 mmH ₂ O initial 635 mmH ₂ O final
-Exhaust system	1,000 mmH ₂ O max.

◆ CONVERSION TABLE

in. = mm x 0.0394	lb/ft = N.m x 0.737
PS = kW x 1.3596	U.S. gal = lit. x 0.264
psi = kg/cm ² x 14.2233	kW = 0.2388 kcal/s
in ³ = lit. x 61.02	lb/PS.h = g/kW.h x 0.00162
hp = PS x 0.98635	cfm = m ³ /min x 35.336
lb = kg x 2.20462	

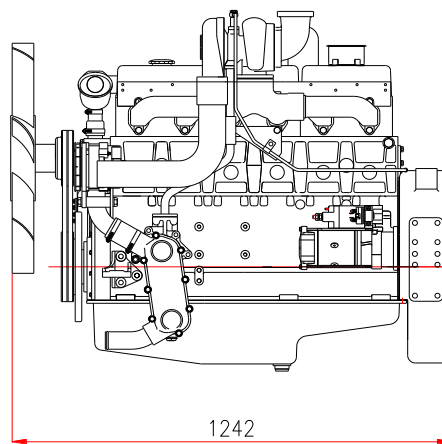
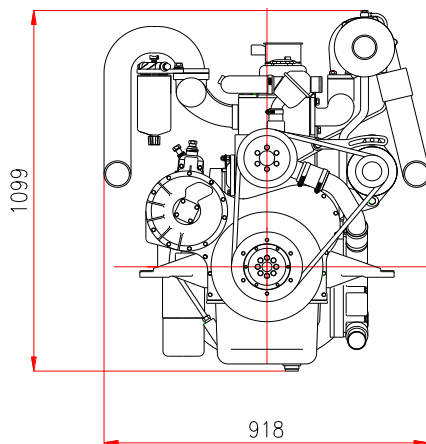

Head office

489, Injung-ro, Dong-gu
Incheon, Korea (22502)
TEL: +82 32 211 1114

Bundang office

14F, HD Hyundai Group's Global R&D Center
477, Bundangsuseo-ro, Seongnam-si
Gyeonggi-do, Korea (13553)